



### Self-Closing Hook Nozzle & Spray Valve

#### Architect/Engineering Specifications:

Self-closing hook nozzle & spray valve. Certified to NSF 61-Section 9 and NSF 372.

Job Name	_____
Model Specified	_____ Quantity _____
Variations Specified	_____
Date	_____

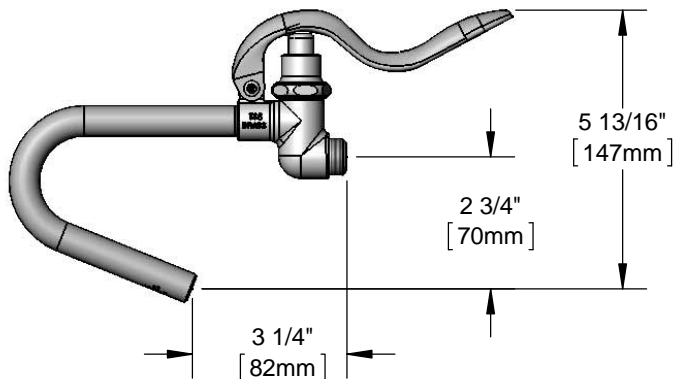
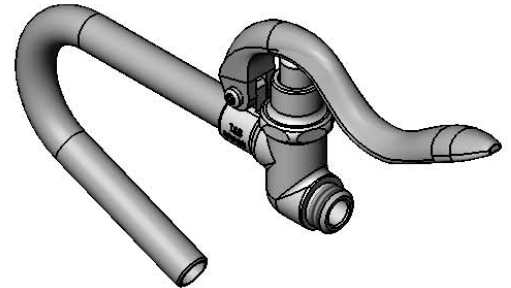

#### Features & Benefits:

- Self-closing hook nozzle & spray valve
- Material: Chrome plated brass

#### Product Compliance:

- ASME A112.18.1 / CSA B125.1
- NSF 61 - Section 9
- NSF 372 (Low Lead Content)



**Warranty:** One Year (Limited)

#### Performance Data:

- Pressure: 20 - 125 psi
- Temperature: 40 °F - 140 °F
- Flow Rate: 5.27 GPM @ 60 psi

